

All components used in this connector conform to RoHS standards.



**Tolerances**  
 1-20=+/-0.2  
 20-30=+/-0.3  
 30-40=+/-0.4  
 40-50=+/-0.5  
 50-100=+/-0.75  
 100-300=+/-1.5  
 Angles=+/-1  
 Dimensions are in Millimeters

Revisions Description/Approved/Date	Approved M.H.	Date 01/15/07
CHG'D HEX SIZE, WAS 11mm	Checked M.H.	Date 01/15/07
	Drawn K.R.E.	Date 01/4/07
NOTES (plating thickness in micro-inches): 1. Per QQ-B-626 2. Per QQ-S-764 3. Per QQ-C-530 4. Per QQ-B-750 5. Per MIL-P-19468 6. Per ZZ-R-765 7. Per WW-T-799 8. Gold pl. 5 min. over nickel pl. 50 min. over copper strike 9. Nickel pl. 100 min. over copper strike 10. Per QQ-P-35 11. Gold pl. min. over nickel pl. 50 min. over copper strike		

Approved by:  
Date:

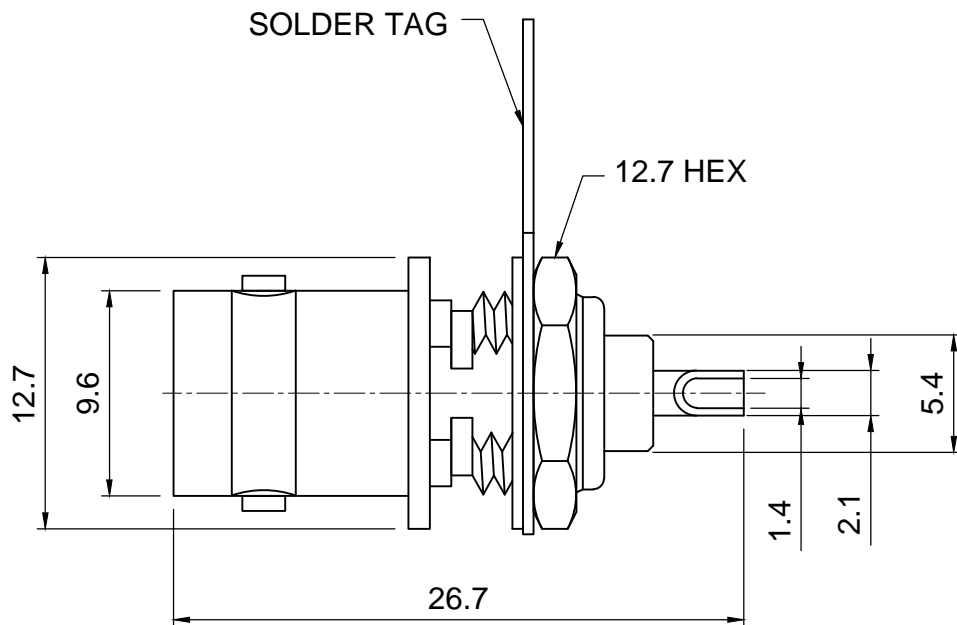

ITEM	MATERIAL	FINISH
Connector Body	Brass, Note 1	Nickel, Note 9
Center Contact	Phosphor Bronze, Note 4	Gold, Note 11
Insulation	Teflon, Note 5	None
Ferrule	--	--
Gasket	Brass, Note 1	Same as body
Hex Nut	Brass, Note 1	Same as body
Lock Washer	Brass, Note 1	Same as body

Lighthouse Technologies, Inc.

9511 Ridghaven Court, Suite B  
San Diego, CA 92123

Part Number:  
**LTI-7BSF43NT**

Description BNC 75 ohm front mount bulkhead jack with solder cup termination.		
Nickel plated brass body, teflon dielectric.		
Scale 2:1	Drawing No. BNC/BSF43	File Name BSF43