

	Tolerances 1-20=+/-0.2 20-30=+/-0.3 30-40=+/-0.4 40-50=+/-0.5 50-100=+/-0.75 100-300=+/-1.5 Angles=+/-1 Dimensions are in Millimeters	Revisions Description/Approved/Date	Approved M.H.	Date 08/20/01
			Checked M.H.	Date 08/19/01
			Drawn K.R.E.	Date 08/17/01
		NOTES (plating thickness in micro-inches): 1. Per QQ-B-626 2. Per QQ-S-764 3. Per QQ-C-530 4. Per QQ-B-750		

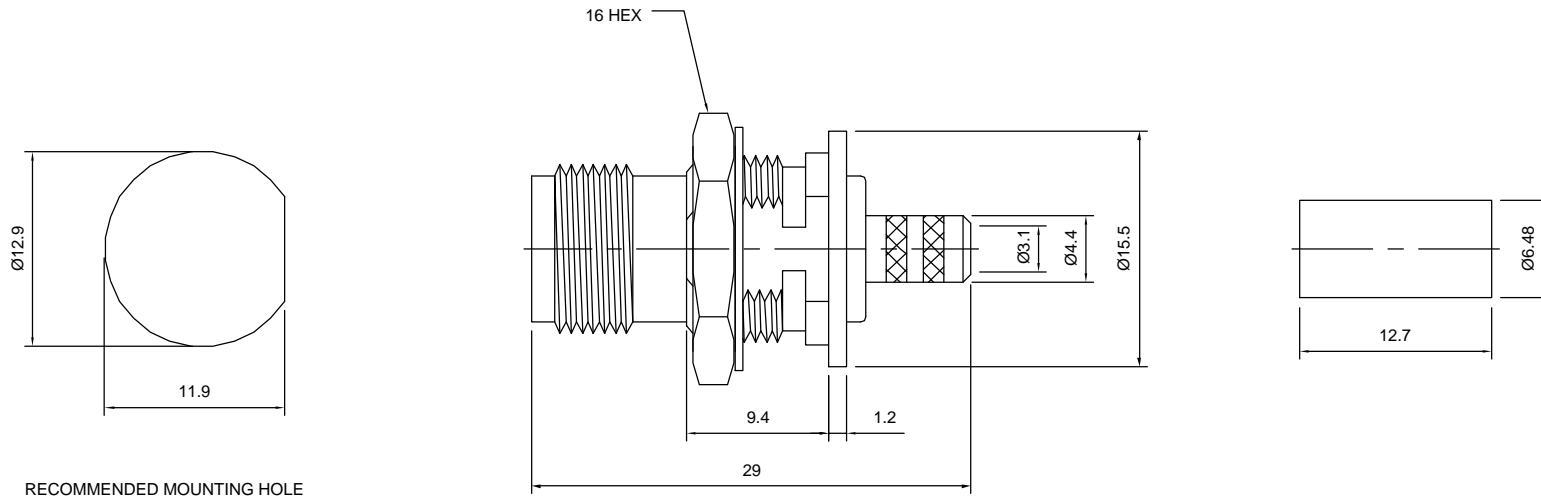

ITEM	MATERIAL	FINISH	Lighthouse Technologies, Inc. 4907 Morena Boulevard, #1411 San Diego, California 92117 Part Number: LTI-TSF13RNT-58		
Connector Body	Brass, Note 1	Nickel, Note 9	Description TNC rear mount bulkhead crimp jack, shorter length		
Center Contact: Female	Beryllium Copper, Note 3	Gold, Note 11			
Insulation	Teflon, Note 5	None	Scale 2:1		
Ferrule	Annealed Copper, Note 7	Same as body			
Gasket	--	--	Drawing No. TNC/TSF13-58		
Hex Nut	Brass, Note 1	Same as body			
Lock Washer	Brass, Note 1	Same as body	File Name TSF13-58		