

Revisions		Approved	Date
Description/Approved	Date	M.H.	06/10/00
		Checked M.H.	Date 06/10/00
		Drawn K.R.E.	Date 06/07/00

Tolerances
 1-20=+/-0.2
 20-30=+/-0.3
 30-40=+/-0.4
 40-50=+/-0.5
 50-100=+/-0.75
 100-300=+/-1.5
 Angles=+/-1

Dimensions are in Millimeters

NOTES (plating thickness in micro-inches):
 1. Per QQ-B-626
 2. Per QQ-S-764
 3. Per QQ-C-530
 4. Per QQ-B-750
 5. Per MIL-P-19468
 6. Per ZZ-R-765
 7. Per WW-T-799
 8. Gold pl. 50 min. over nickel pl. 50 min. over copper strike
 9. Nickel pl. 100 min. over copper strike
 10. Per QQ-P-35
 11. Gold pl. 30 min. over nickel pl. 50 min. over copper strike

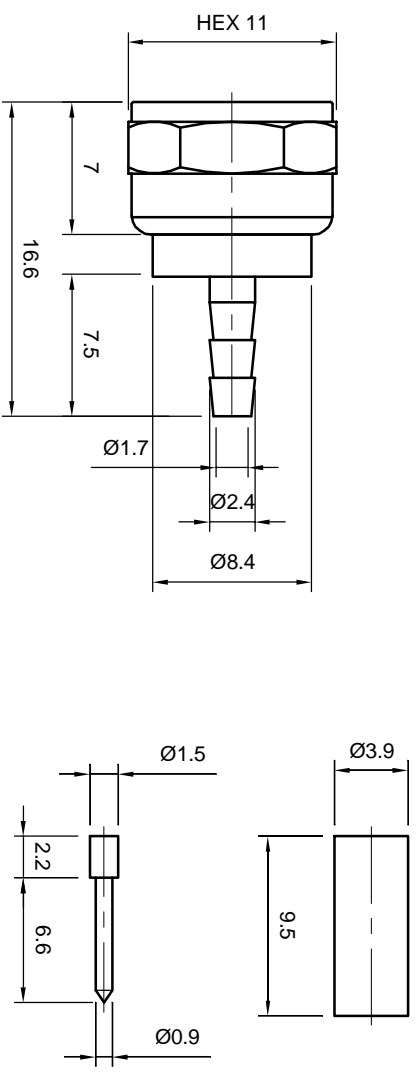

ITEM	MATERIAL	FINISH
Connector Body	Brass, Note 1	Nickel, Note 9
Center Contact: Male	Brass, Note 1	Tin
Insulation	Teflon, Note 5	None
Ferrule	Annealed Copper, Note 7	Same as body
Gasket	--	--
Hex Nut	--	--
Lock Washer	--	--

Lighthorse Technologies, Inc.
 4907 Morena Boulevard, #1411
 San Diego, California 92117

Part Number:
LTI-FSM11NT-179

Description: F crimp plug for RG-179

Scale: 2:1	Drawing No.: F/FSM11-179	File Name: FSM11-179
------------	--------------------------	----------------------