

| Revisions | |
|---------------------------|--|
| Description/Approved/Date | |
| | |
| | |
| | |
| | |
| | |

NOTES (plating thickness in micro-inches)

| | |
|----------------|----------------|
| 5. Per | 6. Per |
| 1. Per 00B-626 | 7. Per |
| 2. Per 00S-764 | 8. Gold nickel |
| 3. Per 00C-530 | copper |
| 4. Per 00B-750 | |

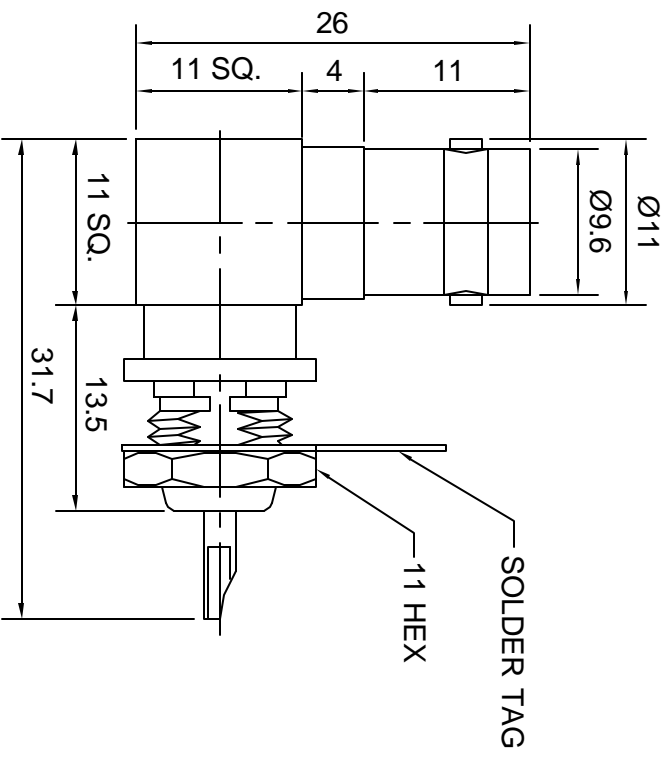

| ITEM | MATERIAL | FINISH | Tolerances | Light |
|------------------------|-----------------|----------------|-------------------------------|---|
| Connector Body | Brass, Note 1 | Nickel, Note 9 | 1-20=+/-0.2 | 4907 |
| Center Contact: Female | Phosphor Bronze | Gold, Note 11 | 20-30=+/-0.3 | San D |
| Insulation | Delrin | None | 30-40=+/-0.4 | Part Number: LT/BSF Description BNC Bulkhead Scale 2:1 File BSF43 |
| Ferrule | -- | -- | 40-50=+/-0.5 | |
| Gasket | -- | -- | 50-100=+/-0.75 | |
| Hex Nut | Brass, Note 1 | Same as body | 100-300=+/-1.5 | |
| Lock Washer | -- | -- | Angles=+/-1 | |
| | | | Dimensions are in Millimeters | |